

the celebrating
Saint



Spring 2008

Alumni Newsletter

St. Paul's College

Saint Paul Lutheran High School
Concordia, Missouri

St. Paul's College High

Capital campaign moves forward as alumni board makes plans for phone brigade

The SPLHS Alumni Board met January 26 and has graciously accepted a very large assignment. Members of the board have agreed to facilitate the process of enlisting Alumni Association volunteers to develop a phone brigade, and their first assignment will be to assist with our capital campaign.

This alumni phase of the capital campaign, *Designed for the Ages*, will take several weeks to complete, as we have an impressive mailing list of alumni totaling nearly 2,500. Individual letters will be mailed and follow up calls made in the near future.

We look forward to a very positive response from you, our deeply supportive alumni, as you receive calls from the phone brigade. This is a time of great opportunity for Saint Paul Lutheran High School & Ministries and our alumni will be a very special part of the success of the capital campaign. As you well know, Saint Paul has a rich heritage of distinction and a vision for excellence. We ask for your prayerful consideration of how God may be moving you to assist in moving forward with this vision. Someone will be contacting you soon.

Envision a vibrant educational environment in which thousands of God's people, from the high school freshman to the senior servant, are equipped to be effective Great Commission leaders.

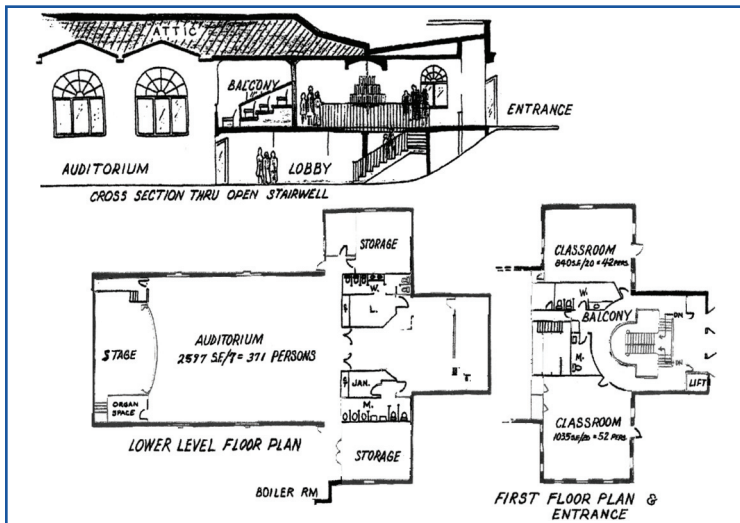

Pictured above is the artist's conception of the Kaeppl Hall renovation which will create a premier worship, performing arts and conference center. The upper level entrance will be an open area of balcony seating, overlooking the auditorium on the lower level. This renovation will allow for larger audiences for worship, assemblies, drama productions, concerts, recitals, and regional academic competition.

This is an exciting task for the Alumni Association which will not only bring to the forefront the wonderful plans being made for our campus, but also hopes to bring forth better unity to each alumni class. Motivation filled the room at the last alumni board meeting as members began talking about the possibility of reaching classmates they haven't seen or had the opportunity to talk with for several years.

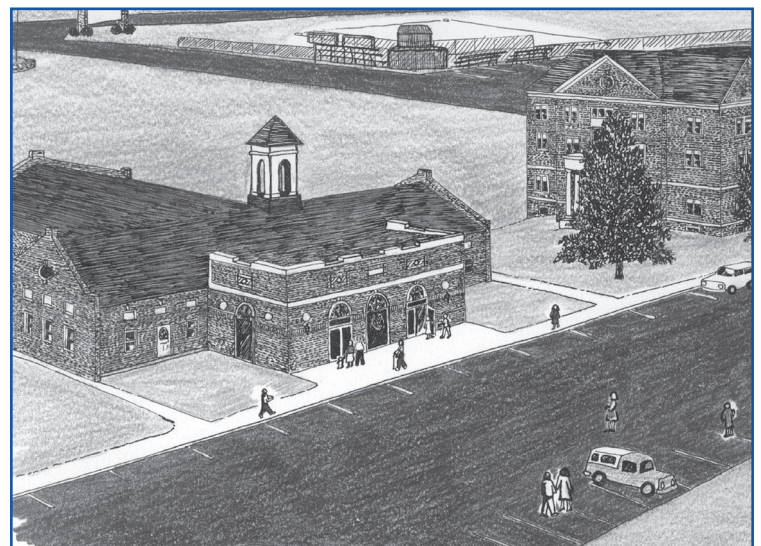

***Yes! I will attend ALUMNI ALL-SCHOOL REUNION 2008
Saint Paul Campus, Concordia, Missouri, June 20-22, 2008
YES! I will send this in by June 1, 2008***

REGISTRATION (each person 18 & older) _____ x \$10.00 = \$_____

ROOM RESERVATIONS (Heilman Dorm: \$30.00 first night; \$15.00 each additional night)
 ¢ Thursday, 6/19 ¢ Friday, 6/20 ¢ Saturday, 6/21 ¢ Sunday, 6/22 \$_____

ROOM RESERVATIONS (Biltz Hall) ¢ Room with 2 queen beds ¢ Room with 1 queen bed
 \$50.00 a night ¢ Thursday, 6/19 ¢ Friday, 6/20 ¢ Saturday, 6/21 ¢ Sunday, 6/22 \$_____

____ Thanks, but I/we will be staying off campus. (Motel information on page 4.)

MEALS (Children 6 & under free, 7-12 half-price.) (Indicate on line below how many for each meal.)

FRIDAY LUNCH (Biltz Hall) _____ x \$6.00 = \$_____

FRIDAY BANQUET (Krueger Hall) _____ x \$10.00 = \$_____

SATURDAY CONTINENTAL BREAKFAST (Biltz Hall) _____ x \$6.00 = \$_____

SATURDAY LUNCH (Biltz Hall) _____ x \$6.00 = \$_____

SATURDAY COOKOUT (Concordia Park) _____ x \$7.00 = \$_____
 (additional charge for special beverages)

SUNDAY CONTINENTAL BREAKFAST (Biltz Hall) _____ x \$2.00 = \$_____
 (for on-campus housing)

TOTAL = \$_____

(If a special diet is needed, contact us and we will work with you)

(Prices reflect advance reservations; additional charge may be added for tickets purchased at the door)

SUNDAY DINNER (Hog Roast at Krueger Dining Hall)

DONATION RECEIVED AT THE DOOR

Name(s): _____
 (please list names of all attending; include maiden name if Saint Paul Alumna)

Address: _____

City: _____ State: _____ Zip: _____

Telephone: Home () _____ Work () _____

Email _____

Name _____ was a member of HS class _____ College class _____

Name _____ was a member of HS class _____ College class _____

Send completed form & payment to Alumni Coordinator, Saint Paul Lutheran High, PO Box 719, Concordia, MO 64020-0719.
 Questions — contact Walter Loeber (660) 463-2238, ext 317; email: splhsalumni@yahoo.com

Air Force Colonel to be reunion banquet speaker



Colonel Anita Hill Wolfe, a graduate of Saint Paul High in 1978 and College in 1979, will be the featured speaker at the 2008 all-school reunion banquet. The reunion is June 20-22, 2008, on the Saint Paul campus.

Anita rose to the rank of Colonel in the U.S. Air Force in January 2007. She currently is commander of the 1st Inpatient Operations Squadron, 1st Fighter Wing, at Langley Air Force Base, Virginia. As

commander she is responsible for approximately 150 personnel and an operating budget of \$2.1 million. She joined the Air Force in 1984.

Following her graduation from St. Paul's College, Anita attended Concordia College, River Forest, Ill., where she earned a degree in social work. She earned a bachelor of science in nursing degree from Saint Louis University in 1984 and a master's degree in cardiovascular nursing in 1994 from University of California at San Francisco.

From July 2004 to July 2006 she was the Chief Nurse Executive/deputy squadron commander at the Spangdahlem Air Base in Germany. For the next 12 months she was the Chief Nurse Executive, Medical Group.

Anita grew up at Corder, Mo., near Concordia. Her sister Lois and her brothers David and John are alumni of Saint Paul (Lois SPCH '72, SPC '74; David, SPCH '76, SPC '77; John, SPLHS '87).

Anita is married to Jerry Wolfe, also a Saint Paul alumnus (SPCH '75, SPC '76). They have one daughter, Lia, 11. Anita's father, Edgar Hill, was a resident at the Lutheran Good Shepherd Home in Concordia. He died February 4. Her mother is also deceased.

The reunion banquet will take place on Friday evening of the extended weekend event. See the previous pages for schedule and registration information.

Alumni Jottings...

(To share information about yourself in the next newsletter (mid-July) or on the alumni Web site, email the information to splhsalumni@yahoo.com, or mail to P.O. Box 719, Concordia MO 64020.)

SPLHS '97, Joel Oetting, and SPLHS '05, Chris Maggert, both of Concordia, volunteered their time, expertise and equipment to construct a sidewalk from the parking lot... (more on Website).

(For complete list of Alumni Jottings, go to www.splhs.org, click on ALUMNI, on the left click on ALUMNI UPDATES.)

Receive a 125th anniversary gift

The Alumni Association will send you a 125th anniversary commemorative gift for your contribution.

For a \$50 contribution, receive a key tag featuring the cupola; for a \$100 contribution, receive a solid pewter ornament featuring Baepler Hall; for a \$200 contribution, receive a sword letter opener featuring the cupola.

See these gifts on the alumni Web site by going to www.splhs.org, ALUMNI, then ALUMNI UPDATES.

FOR MORE INFORMATION ON

- * alumni in the military
- * reunions in the planning
- * "lost" alumni
- * Alumni Jottings
- * other information and stories

go to www.splhs.org, click on ALUMNI, then on the left side, click on ALUMNI UPDATES

Baccalaureate Service

Saturday, May 17, 2008 • 10:00 a.m.
St. Paul's Lutheran Church, Concordia

Graduation

Saturday, May 17, 2008 • 1:30 p.m.
Weis Gymnasium

2008 Singing Saints Spring Tour

If you are in the area of a Singing Saints concert, come, hear and meet the Singing Saints and William Gasau.

Tuesday	March 11	7:30 p.m.	Christ the King Lutheran	Lake Ozark, Missouri
Wednesday	March 12	7:00 p.m.	Our Savior Lutheran	Tulsa, Oklahoma
Thursday	March 13	7:00 p.m.	Zion Lutheran	Abilene, Texas
Friday	March 14	7:00 p.m.	Immanuel Lutheran	Roswell, New Mexico
Saturday	March 15	5:30 p.m.	Trinity Lutheran	Pueblo, Colorado
Sunday	March 16	9:00 a.m.	Redeemer Lutheran	Colorado Springs, Colorado
Sunday	March 16	7:00 p.m.	Trinity Lutheran	Franktown, Colorado
Monday	March 17	7:00 p.m.	Holy Cross Lutheran	Dodge City, Kansas
Tuesday	March 18	7:00 p.m.	Messiah Lutheran	Emporia, Kansas
Sunday	March 30	7:00 p.m.	St. Paul's Lutheran (Home Concert)	Concordia, Missouri

Saint Paul Alumni Association

Seventh All-School Reunion — June 20-22, 2008

Tentative Schedule of Events

Thursday, June 19

3:00 to 7:00 p.m.
After hours

Registration and early check-in at Biltz Hall
Contact Paula (Kunkel) Hass, (816) 694-8053

Friday, June 20

8:00 a.m. to 5:00 p.m.
10:30 a.m. to noon

Registration at Biltz Hall
Guided tour of Saint Paul — Walter Loeber
Historical Focus at Fine Arts Building — Ed Nierman
Lunch in Biltz Hall Conference Room
Community tour; meet in front of Biltz Hall
Alumni choir practice — Fine Arts William Gasau, Director
Pre-banquet social hour, Krueger North Dining Hall
Class photos
Alumni banquet, Krueger Dining Hall
Brief comments from Rev. Mark Nebel, Rev. Paul Mehl,
Rev. Ken Wesemann, Mr. Walter Loeber
125th Anniversary video
Guest Speaker — Col. Anita Hill Wolfe,
Commander, 1st Inpatient Operations Squadron

Noon to 2:00 p.m.
2:00 to 3:30 p.m.
3:30 to 4:30 p.m.
5:00 to 6:00 p.m.
5:00 to 6:00 p.m.
6:00 p.m.

Saturday, June 21

7:00 to 8:30 a.m.
7:00 a.m.
8:30 a.m.
10:00 a.m.
Noon to 1:30 p.m.
1:00 to 5:00 p.m.
2:00 to 5:00 p.m.
5:00 p.m.
8:30 p.m.

Continental breakfast
Open golf, Tri-City Country Club, Emma, Mo.
Tour of winery in Waverly, art gallery in Alma, other area attractions
Weis Gym and Annex open for pre-bidding, silent and live auctions
Lunch in Biltz Hall Conference Room
Family swimming available at Concordia Aquatic Center
Class reunions
BBQ cookout (by Randy Hinck) and social at Concordia Park shelter house
Vespers in Kaepfel Chapel
Preacher: Dr. Walter Rosin, former president of SPC and SPCH

Sunday, June 22

8:00 & 10:30 a.m.
9:15 a.m.
11:00 a.m. to 1:00 p.m.
10:00 a.m. to 2:00 p.m.
2:00 to 4:00 p.m.

Worship service at St. Paul (Holy Communion in 10:30 service)
Bible class and Sunday school
Hog roast dinner in Krueger Dining Hall
Silent auction in Weis Gym (sections begin closing at 1:00 p.m.)
Live auction in Annex

Motel Information

Budget Inn & Suites, Concordia, 660-463-2135 (cheapest rates; no breakfast)

Days Inn, Concordia, 660-463-7987 (indoor pool and hot tub)

Travelodge, Concordia, 660-463-2114 (new, local ownership; known for clean rooms)

Camelot Inn Motel, Higginsville Junction, 9 miles west of Concordia, 660-584-3646 (outdoor pool; pets allowed)

Super 8 Motel, Higginsville Junction, 9 miles west of Concordia, 660-584-7781 (AAA and AARP – 10% discount)

Super 8 Motel, Sweet Springs, 10 miles east of Concordia, 660-335-4888 (AAA and AARP – 10% discount)

People's Choice Motel, Sweet Springs, 10 miles east of Concordia, 660-335-6315 (clean rooms; discounts available)

Make reservations for rooms in Biltz Hall or at motels as soon as possible.

**A Mighty Fortress is our God, a trusty Shield and Weapon; He helps us free from every need, that hath us now o'ertaken.
The old evil foe, now means deadly woe; Deep guile and great might, are his dread arms in fight; On earth is not his equal.**

What comes to mind when you read these words? Did you start to hum the melody or read the words in the cadence that you sing them?

At Saint Paul Lutheran High School, we continue to teach from generation to generation the Good News of God's salvation and mighty power. When you are near Concordia, you are welcome to stop in for chapel service Monday, Wednesday or Friday from 8:50 to 9:15 a.m. We would love to have you come pray, sing and worship with us.

We at the Alumni Association help every day to support Saint Paul Lutheran High School and need your financial and prayer support. All contributions to the Alumni Association are tax deductible and 100% of the dollars are used to finance the Alumni Association's supportive activities of our school. To help support us financially, please make checks payable to "**Saint Paul Alumni Association**" and return to us in the attached envelope.

..... cut here See page 3 for contribution gift.

I am donating \$ _____ to help Saint Paul Lutheran High School through the Alumni Association.

I am donating \$ _____ to help Saint Paul Lutheran High School through the alumni coordinator position.

My contribution is to honor _____ (see article on page 5)

We also need your help in voting for this year's Outstanding Alumnus. (see the back of this page for information about nominees)
Please return your vote in the enclosed envelope. The Outstanding Alumnus nominees are:

- _____ Theodore K. Bundenthal
- _____ Robert Lange
- _____ James Pragman

_____ I will continue to support Saint Paul Lutheran High School with my prayers.

_____ My name labels have incorrect information. Changes are noted above.

_____ I have news to share with other Alumni. Please contact me. My e-mail is _____.

P.S. Don't forget to use one of your address labels on the outside of the return envelope! We hope these labels help you remember our ministry in prayer every time you use them.

..... cut here

Vote when you contribute

Beginning this year, alumni may vote for their favorite faculty member by giving a contribution to the Saint Paul Alumni Association in honor of that faculty member. Vote on the above form and send with your contribution.

Faculty members eligible to be honored in this way are those who are no longer serving Saint Paul and who taught for five years or longer at the school. A list of eligible faculty members is posted on the alumni Website, www.sphls.org. Click on ALUMNI, then ALUMNI UPDATES.

Saint Paul Hog Roast and Auction — June 22, 2008

Hog roast dinner served in Krueger Dining Hall 11:00 a.m. – 1:00 p.m.

Silent auction in gym — bidding 10:00 a.m. – 1:00 p.m.

Live auction in Annex begins at 2:00 p.m.

All proceeds go directly for the support of Saint Paul High School

Alumni are welcome to bid and support the high school

Consider a class donation in bidding for the tree or naming the quad

DONATIONS FROM ALUMNI ARE WELCOME

SILENT AUCTION items: new household items, food chain coupons, craft items, fleur-de-lis items

LIVE AUCTION items: vacation and sports packages, precious jewelry, collectibles, furniture

If you wish to make a donation, call the school at 660-463-2238

To have your items or items from a business or person you have solicited

listed on the sale bill, please contact the school by May 15.

Items may be brought or mailed to the school

Candidates for 2008 Saint Paul Alumnus of the Year award

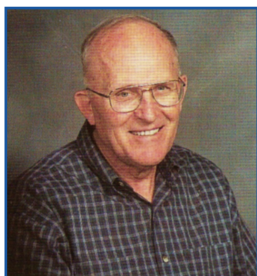

Vote on the form at the bottom; return by June 1.

Theodore K. Bundenthal
SPCH '47; SPC '49;

M.A. Washington University, St. Louis, '60; PhD, University of Nebraska, Lincoln, '70; taught at Concordia Seminary, Springfield, Ill.; Concordia, River Forest; Concordia, Seward; Alabama Lutheran, Selma; pastorate in Brazil, Ind.; directed building of chapels and student centers at East Lansing, Mich., and Michigan State University; military chaplain; retired USAF colonel with 32 years service; Around the World. Investigative/research Tour, '62; Fullbright Scholar in India, '86; served as senior intelligence officer for U.S. Department Intelligence Agency; married with five children.

Robert Lange
SPCH '49; SPC '51;

Taught English, German and speech at SPCH and SPC '59-'61; parish pastor in Kirksville, Mo.; campus pastor for Northeast and Southeast Missouri State Universities, and Illinois State in Normal; established mission congregations in Memphis and Milan, Mo.; counselor for Synod's Campus Ministry; served in U.S. Army in Europe '52-'54; involved in building churches in Kirksville, Cape Girardeau and Normal; serves as one of the founders of Saturday Outreach School in St. Louis; board member of the Saint Paul Alumni Association; married with four children.

James Pragman
SPCH '56; SPC '58;

Master of Sacred Theology degree '71 and Doctor of Theology degree from St. Louis seminary; pastorates in Kirkwood, Mo., Seward, Neb., and Mankato, Minn.; professor of theology at Concordia, Seward '70-'86, and acting president '85-'86; executive assistant to the president of Minnesota South District; wrote and published articles and essays on Lutheran doctrine of the holy ministry; served as a vice-president of the Nebraska and Minnesota South districts; currently a member of Board of Regents, Concordia Seminary, Fort Wayne; married with two daughters.

cut here

I am donating \$_____ to help Saint Paul Lutheran High School through the Alumni Association.

I am donating \$_____ to help Saint Paul Lutheran High School through the alumni coordinator position.

My contribution is to honor _____ (see article on page 5)

We also need your help in voting for this year's Outstanding Alumnus. (see the back of this page for information about nominees)

Please return your vote in the enclosed envelope. The Outstanding Alumnus nominees are:

- ___ Theodore K. Bundenthal
- ___ Robert Lange
- ___ James Pragman

___ I will continue to support Saint Paul Lutheran High School with my prayers.

___ My name labels have incorrect information. Changes are noted above.

___ I have news to share with other Alumni. Please contact me. My e-mail is _____.

P.S. Don't forget to use one of your address labels on the outside of the return envelope! We hope these labels help you remember our ministry in prayer every time you use them.

cut here
